

Assembling CMR Accessories for the Amimon Connex Mini Quick Guide



CONNEX MINI

Expanding Connex Capabilities with CMR Accessories

Convenient use of the Amimon Connex Mini sets for **non-aerial videography rigs**

Completely self-contained transmitter and receiver battery power

The banner features the Connex Mini logo in red and grey, with two small images of the device on either side. Below the text are two larger images of the device: one with a red lens and one with a blue lens.



A. Installing the Connex Mini CMR transmitter battery support and mounting cage

Step 1. Remove the top two screws from the Connex Mini Cage as shown below.

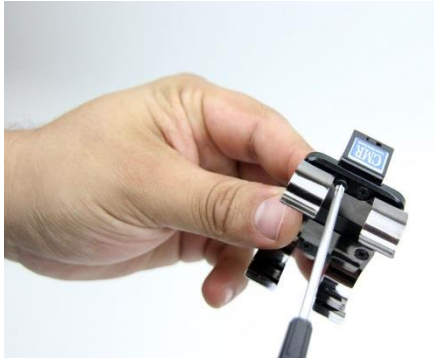

Remove the two screws located between the battery clips that lock the small right angle bracket

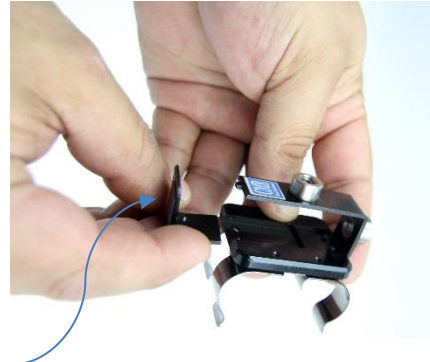

Remove the small right angle bracket.

Step 2. Insert the Connex Mini into the cage.



Main Mounting Bracket



Step 3. Position the hole in the small right angle bracket over the small protruding tab on the main mounting bracket. Replace the two screws that were removed in step 1. and tighten firmly.



Step 4. Attach the provided rod antennas to the Connex Mini by screwing them on.



Step 5. Insert the battery. Make sure the battery power port and the Connex Mini power port are on the same side.



Step 6. Insert power cable.



Step 7. Insert a micro HDMI cable or (recommended) insert the HDMI micro to standard converter and locking bar as shown below. Secure the locking bar with the ¼-20 nut.

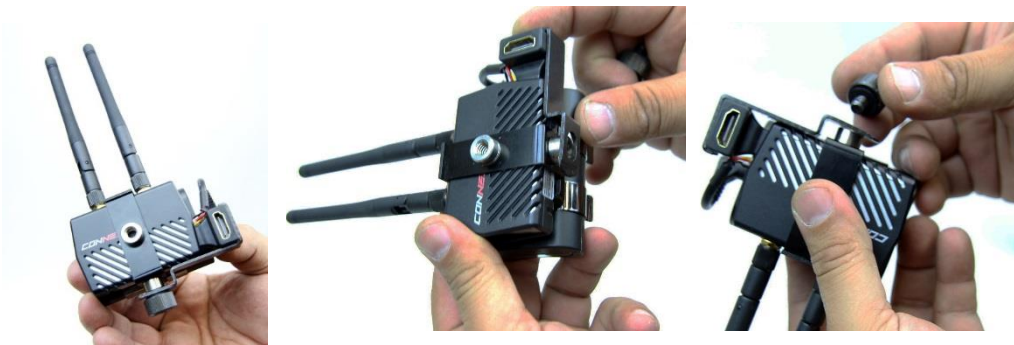

Note: the HDMI locking bar nut also has a ¼-20 tapped hole for mounting the transmitter.

B. Installing the Connex Mini CMR Receiver Battery Support



Step 1. Simply Screw the battery cage captive thumb screw into the bottom of the ¼-20 tapped hole on the receiver.

Mount the receiver assembly to your gear (eg. monitor, light stand, etc.) using the ¼-20 tapped hole on the bottom of the thumb screw.

Step 2. Insert the battery into the receiver battery cage as shown in picture, so that the power ports are on the same side. Insert the power cable.



C. Removing the Batteries



This applies to both the transmitter and the receiver. Hold the cage in your hands so that you have a grasp of the cage and the battery. Use your thumbs to press up on the clips and your index fingers to push out on the battery. Remove battery.

D. Removing the Battery Clips if the Lithium Battery is not used.



The battery clips can be removed by unscrewing the 4 screws. Save the screws and clips for future use. You might decide to do this to minimize the transmitter package size when using the D-tap power cable. (note: the D-tap power cable must be purchased separately)

E. Lithium Battery Operation

The Connex Mini transmitters and receivers do not have power (on/off) switches, so they power up whenever voltage is applied. The lithium batteries have a power button to turn them on and off. You must press and hold the button for about 2 seconds to either turn on, or turn off the battery.

Note: The battery must be turned off when being charged. Watch for the walking lights to confirm charging is taking place. Charging time is about 4 hours.

F. Connex Mini Operational Notes (See the Connex/ Connex Mini User Guide for more detailed information)

The Connex Mini provides plug and play wireless transmission of HDMI video signals, but does not transmit audio.

Frequency selection from one of 9 available channels is automatic.

The Connex Mini can transmit to up to 4 receivers simultaneously.

Refer to the Connex/ Connex Mini User Guide for information about how the two LEDs (video and network) on the transmitter (air unit) and receiver (ground unit) show the status of a connection and video input.

A Link to Connex/Connex Mini User Guide is here....

<http://connex.amimon.com/sites/connex/UserContent/files/CONNEX%20and%20CONNEX%20Mini%20User%20Guide.pdf>

Note that the receiver has an On Screen Display (OSC) button to turn on, or turn off the On Screen Display. Normally you would have the On Screen Display turned off so that the OSD information is not overlaid onto the camera video.